



4/30 Park Road Bellambi, NSW



3



1



2

Sandy Toes and Cozy Abodes: Bellambi Townhouse Living Awaits

This immaculate townhouse at 4/30 Park Road, Bellambi presents an ideal opportunity for first-home buyers seeking the ultimate coastal lifestyle or investors looking for a low-maintenance property with future growth. Nestled in a small, well-maintained strata complex, this home offers easy access to both Bellambi and Corrimal's vibrant community hubs, and is just moments from pristine beaches.

Price:

Contact Agent

Property Highlights:

? Sunlit Open-Plan Living:

? Timeless Kitchen:

? Private Courtyard Oasis:

Outdoor entertaining is a breeze with the sunlit North facing patio, ideal for alfresco dining or summer BBQs. The level grassy yard provides a private, secure space for kids and p

Ethan Hennessy

Max Fairnie

02 4267 5377

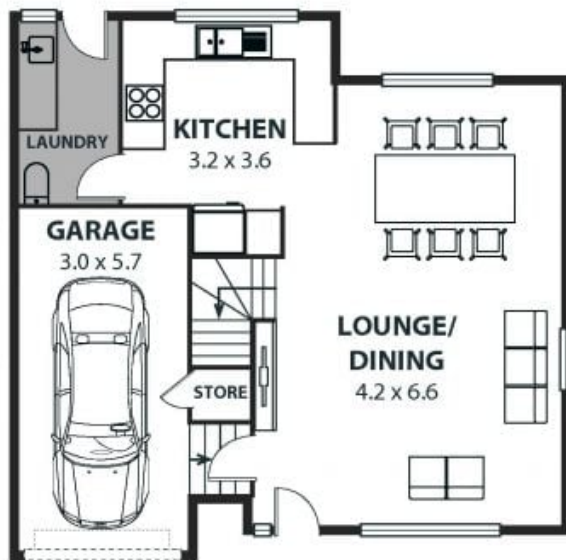
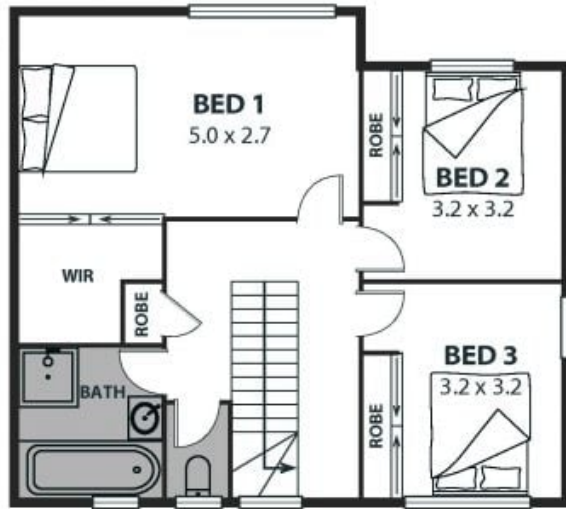

4/30 Park Road, Bellambi

Internal Space 122m²



Plans shown are for presentation purposes and are not part of any legal document with effect and are subject to error, omissions, inaccuracies and should not be used in sole and accurate reference. Particulars given are for general information only and do not constitute any representation on the part of the vendor or agent. No liability will be accepted.