



6/82 New Dapto Road Wollongong, NSW



2



2



1

Peak Perfection: Escarpment Views in the Heart of the City

Perfectly positioned to capture stunning escarpment views, this stylish two-level apartment is an entertainer's dream. With its premium design, open-plan living, and modern features, it's an ideal choice for first home buyers or savvy investors seeking a high-quality return in Wollongong's vibrant inner city.

Property Highlights:

? Sleek Contemporary Design:

Nestled within a beautifully maintained complex, this home impresses with manicured gardens and striking modern architecture. The open-plan living and dining area flows seamlessly, offering a light-filled space perfect for everyday relaxation or hosting guests.

? Gourmet Kitchen:

Step outside to a large, covered balcony with sweeping views of the escarpment, creating t

Inspect:

Price: Price Guide \$650,000- \$700,000

Council Rates: \$378.48 p/q

Water Rates: \$172.79 p/q

Ethan Hennessy

Max Fairnie

02 4267 5377

STORAGE
2.0 x 1.2

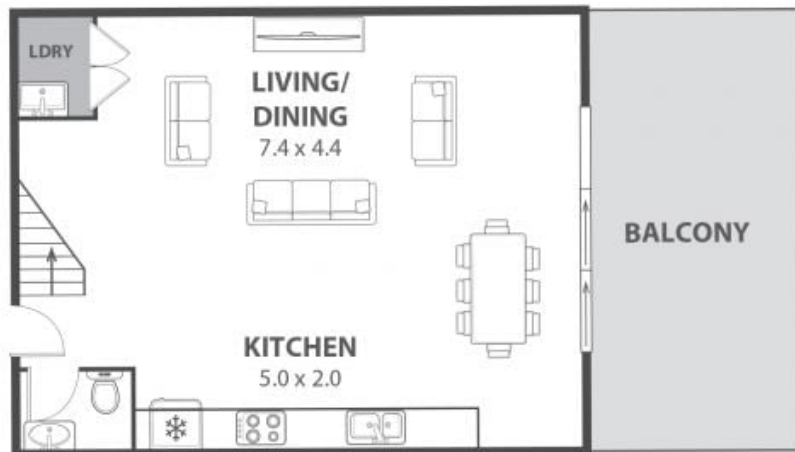
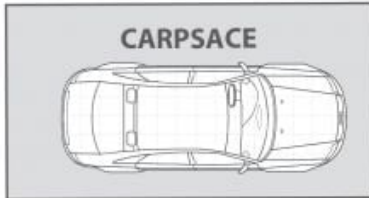

6/80-84 New Dapto Road, Wollongong

Internal Space 118m²



Plans shown are for presentation purposes and are not part of any legal document in force and are subject to errors, omissions, inaccuracies and should not be used as sole and accurate reference. Particulars given are for general information only and do not constitute any representation on the part of the vendor or agent. No liability will be accepted.