



151 Kembla Street Wollongong, NSW



4



1

Superb residential and commercial potential!

Offering both residential and commercial zoning in one of Wollongong's most desirable locations, this property offers endless potential and undeniable business and lifestyle appeal.

LOCATION

Set in a coveted location boasting both residential and commercial zoning, this location offers an incredible lifestyle and superb potential for your business.

Emporium On Swan is ready to serve up your morning coffee a five-minute walk away (approx.), while the fabulous dining, shopping and entertainment of the CBD await within walking distance of home. Adding extra convenience are Aldi and Woolworths, both a short stroll away.

Families will enjoy easy school mornings ahead, with Coniston Public School an easy walk away and Keira High School a seven-minute drive from home (approx.), while regular Sydney-bound trains from nearby

Price: Price Guide \$1,350,000 - \$1,400,000

Council Rates: \$590.15 p/q

Water Rates: \$265.76 p/q

Ethan Hennessy

Shawn Condello

02 4267 5377

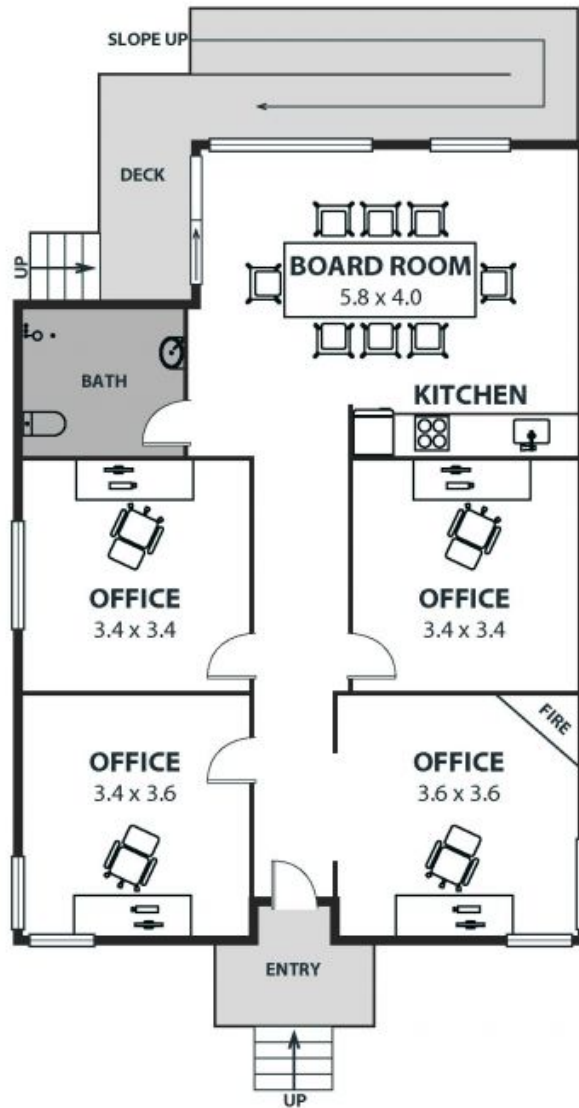

151 Kembla Street, Wollongong

Internal Space 96m²



Plans shown are for presentation purposes and are not part of any legal document or file and are subject to errors, omissions, inaccuracies and should not be used as sole and accurate reference. Particulars given are for general information only and do not constitute any representation on the part of the vendor or agent. No liability will be accepted.